



**MOVE INN ESTATES**

MAKING THE RIGHT MOVE



## Waterside Road

, Southall, UB2 4RA

**Price Guide £225,000**

A modern and well-presented two-bedroom apartment set within the popular Waterside development in Southall, ideally positioned next to Ealing Hospital.

The apartment offers a bright open-plan living and dining area with a contemporary fitted kitchen, perfect for modern living. Both bedrooms are well sized, with the principal bedroom benefiting from ample storage, while the bathroom is finished to a clean, modern standard.

Residents benefit from a secure building, well-maintained communal areas and a peaceful waterside setting, while still enjoying excellent connectivity. The property is conveniently located close to local shops, amenities and transport links, with easy access to Southall Station, the A40 and surrounding areas including Ealing and Hayes.

Ideal for first-time buyers, professionals or investors, this apartment offers a strong combination of location, comfort and convenience.

### Viewing

Please contact our Move Inn Estates - Sales Office on 0208 574 4966 if you wish to arrange a viewing appointment for this property or require further information.

- Two bedroom apartment
- Waterside development
- Open-plan living
- Modern fitted kitchen
- Secure building
- Well-maintained communal areas
- Next to hospital
- Excellent transport links



2



1



1



C



Floor Plan

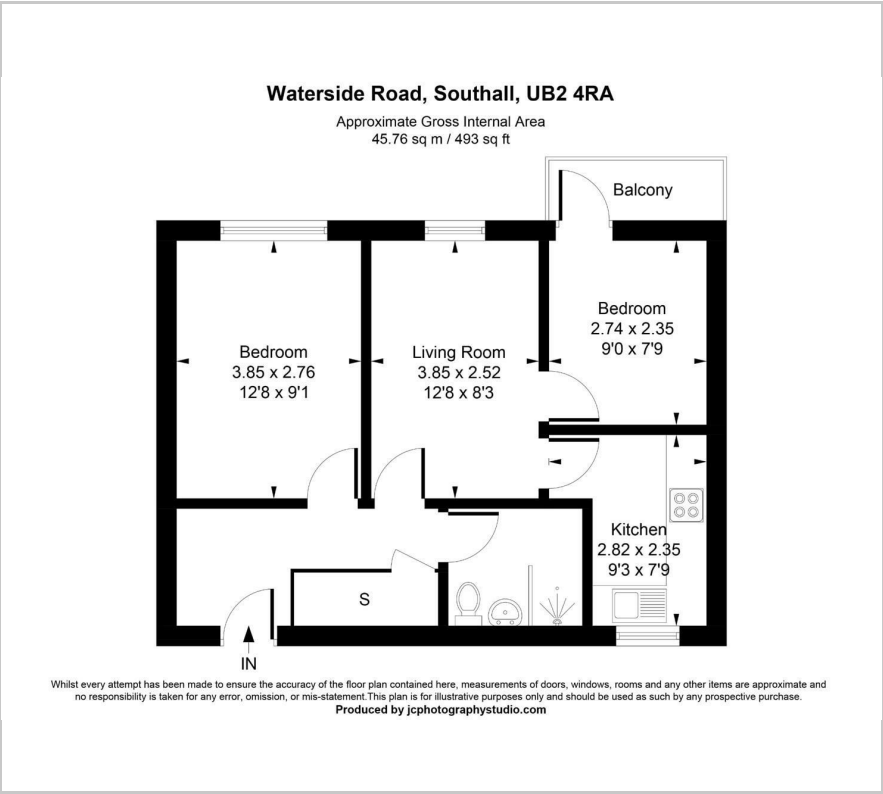

Area Map



Energy Efficiency Graph

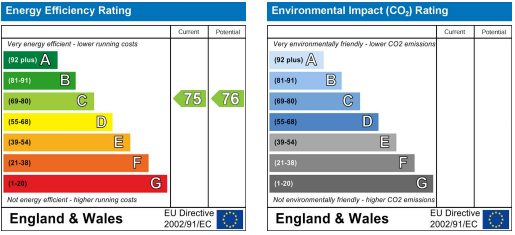

These particulars, whilst believed to be accurate are set out as a general outline only for guidance and do not constitute any part of an offer or contract. Intending purchasers should not rely on them as statements of representation of fact, but must satisfy themselves by inspection or otherwise as to their accuracy. No person in this firms employment has the authority to make or give any representation or warranty in respect of the property.